

■GB-804A、GB-1004A

單位：mm

表面形

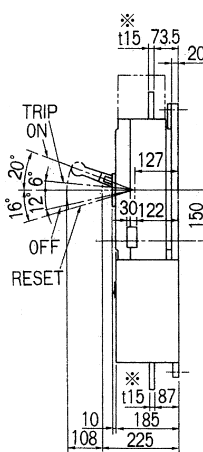
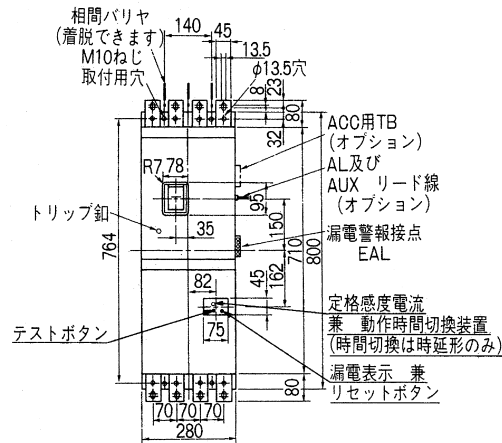

穴明寸法

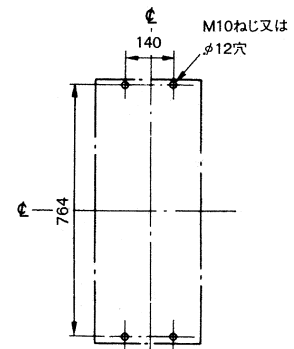

GB-804Aはt10
GB-1004Aはt15

裏面形(SD)

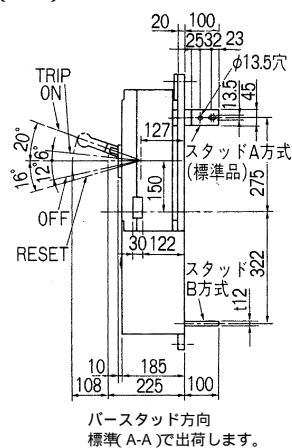

穴明寸法

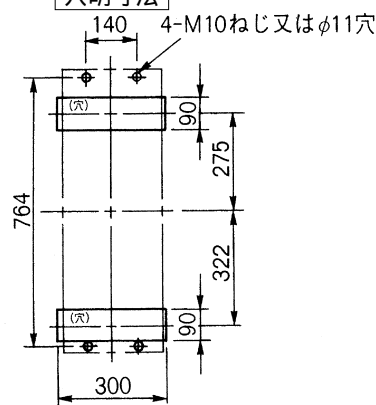

表板穴明寸法

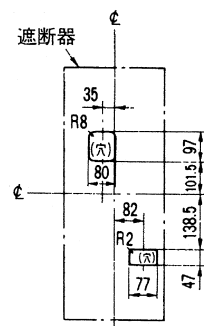

寸法は遮断器の窓枠に対して片側1mmのすき間をもたせた場合です。

埋込形(**FP**)

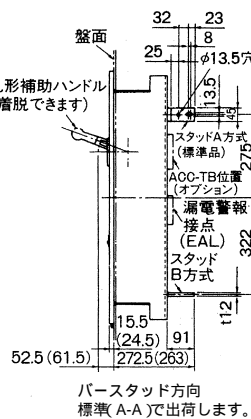
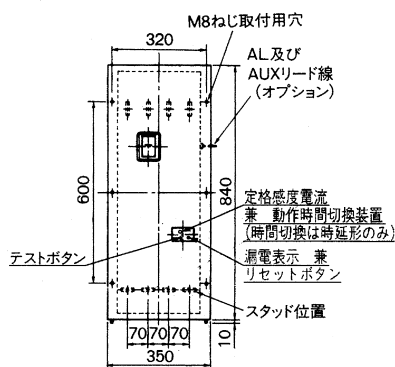

穴明寸法

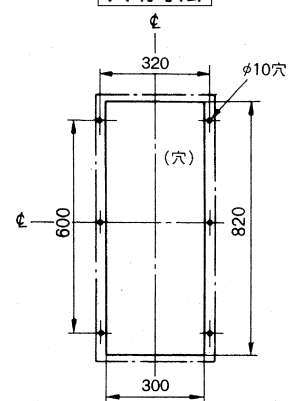

GB-804A

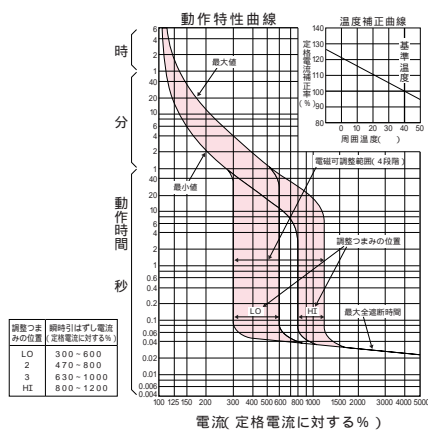

GB-1004A

